

07-0727 ARCHITECTURAL DRAWING

AREA STATEMENT

1. PLOT AREA (AS PER DRAWING) : 300.02 SQM.
2. PLOT AREA (AS PER DEED) : 300.02 SQM.
3. PLOT AREA (AS PER DEED) : 300.02 SQM (14.55% OF PLOT AREA)
4. PROPOSED GROUND COVERABLE : 164.73 SQM (54.91% OF THE PLOT AREA)
5. GROUND FLOOR AREA : (163.53 + 1200) = 1415.53 SQM.
6. FIRST FLOOR AREA : (194.72 + 1200) = 2320.72 SQM.
7. SECOND FLOOR AREA : 160.50 SQM.
8. FOURTH FLOOR AREA : 160.50 SQM.
9. TOTAL COVERED AREA : 743.53 SQM.
10. TOTAL COVERED AREA : 743.53 SQM.
11. OPEN GREEN AREA : 12.19 SQM (4.06% OF PLOT AREA)
12. OPEN USE AREA IN GROUND FLOOR : 28.03 SQM.
13. OPEN USE AREA IN GROUND FLOOR : 154.51 SQM.
14. TOTAL OPEN AREA : 166.72 SQM.
15. TOTAL EMPTIED AREA : 56.47 SQM.

CAR PARKING STATEMENT

PROPOSED TOTAL COVERED AREA - 743.53 SQM.
 ACTUAL AREA PROVIDED FOR COVERED CAR PARKING = (12.5 X 3) = 39 SQM.
 REQUIRED CAR PARKING = 303 - 65.47/150 = 4.33 NOS. i.e. 4 NOS.
 CAR PROVIDED FOR SHOP = 0 (1.5 PARKING SPACE / 100 SQM FLOOR AREA)
 FULLY COVERED CAR PARKING PROVIDED - 4 NOS.
 OPEN CAR PARKING PROVIDED - 0 NOS.
 TOTAL CAR PARKING PROVIDED - 4 NOS.

F.A.R. STATEMENT

PROPOSED F.A.R. = 164.73/300.02 = 0.54907
 PERMITTED F.A.R. = 0.54907
 TOTAL COVERED AREA / TOTAL EMPTIED AREA / PLOT AREA = 743.53 / 166.72 = 4.46

BUILTUP AREA CALCULATION

NO.	FLOOR	AREA (SQM)	REMARK
1.	G.F.	1415.53	GROUND FLOOR AREA
2.	1ST F.	2320.72	FIRST FLOOR AREA
3.	2ND F.	160.50	SECOND FLOOR AREA
4.	4TH F.	160.50	FOURTH FLOOR AREA
5.	TOTAL	743.53	TOTAL COVERED AREA

APPROVED BY

NAME / SIGN. OF THE APPLICANT
 SRI PRABHAT KAMAL BEZBROUJAH
 FLAT 41, 17, LOWER RANGE, KOKKATA, 700017

CERTIFICATE OF THE CIVIL ENGINEER

CERTIFIED THAT THE STRUCTURAL DRAWING AND DESIGN OF BOTH THE BUILDINGS AND THE FOUNDATION DESIGN HAS BEEN MADE CONSIDERING THE SOIL TEST REPORT, AS PER THESE RULES AND THE REGULATIONS MADE UNDER THE ACT AND ALSO CONSIDERING ALL POSSIBLE PROVISIONS REGARDING THE FIRE PROTECTION AS PER THE PREVALING INFORMATION IS FURNISHED BY ME OR ANY VIOLATION OF THE PROVISIONS OF THESE RULES OR THE PREVALING NATIONAL BUILDING CODE IS FOUND IN ANY SANCIONING AUTHORITY FOR OBTAINING SANCTION.

NAME / SIGN. OF THE ARCHITECT

NAME / SIGN. OF THE ARCHITECT
 PROJECT: PROPOSED G+V RESIDENTIAL BUILDING OF SRI PRABHAT KAMAL BEZBROUJAH AT PREMISES NO.07-0727, PLOT NO. 2643 IN AA-41 OF NEW TOWN, KOLKATA

BOLD STROKES DESIGN STUDIO
 Architecture | Interior | Design
 Contact No. +91807276225
 +919531781471

FLOOR PLANS & DETAIL DRAWINGS

DESIGN BY	DATE
FRONT BISWAS	15/01/2023
DATE	15/01/2023

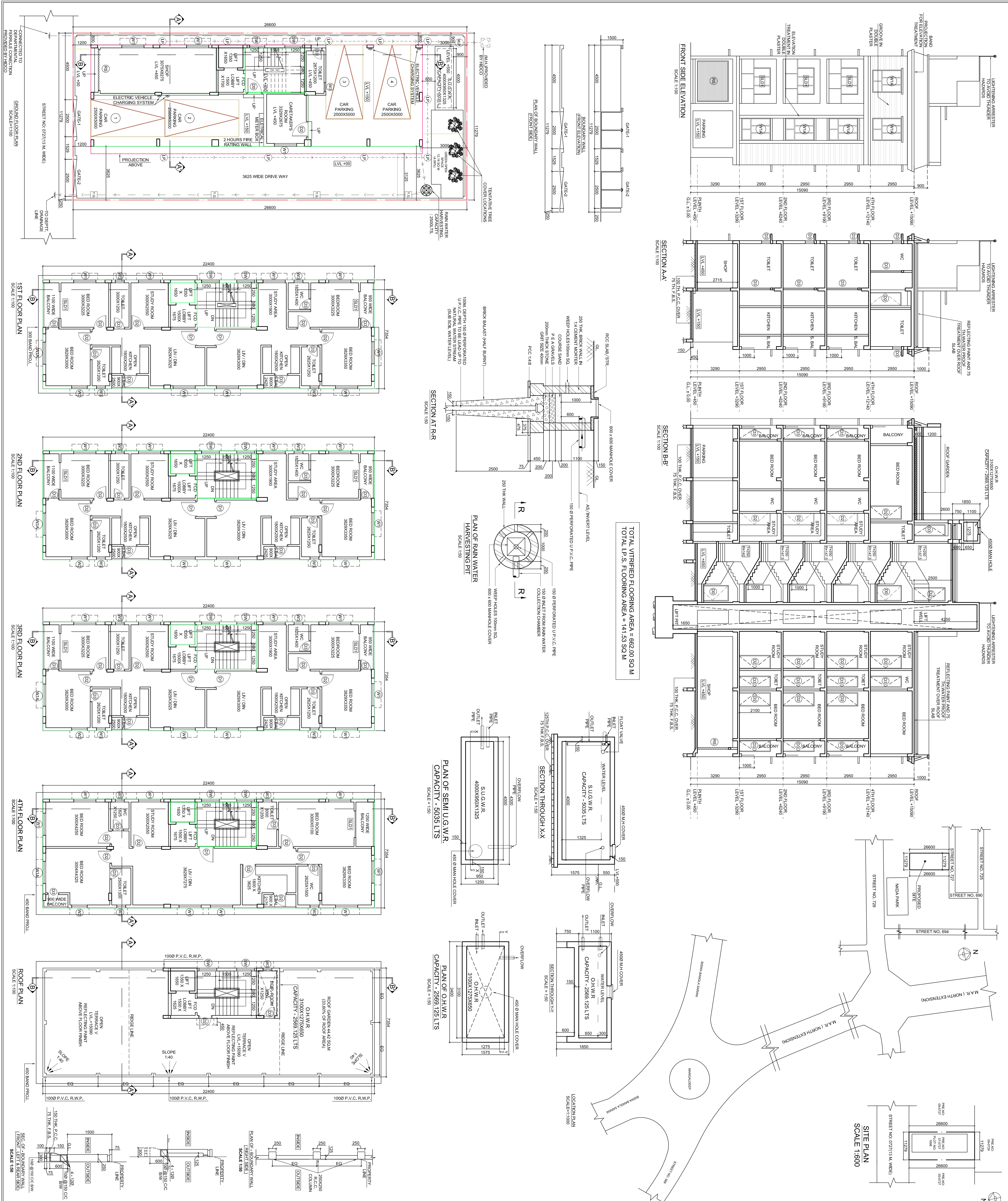

TOTAL UNFITTED FLOORING AREA = 66200 SQ M
 TOTAL I.P.S. FLOORING AREA = 14153 SQ M

